

# Technical instructions

Follow the instructions to customize your wristband with our online designer using our template.

Side 1



Side 2



..... Print area

The template we provide you with corresponds to side number 1 of the lanyard, your personalisation will automatically be replicated on side number 2. Only the front side will be printed, for double-sided printing please contact us.

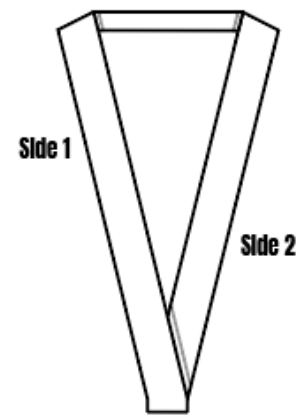

## 1. Download the template

Download the template by clicking on the “download template” button or via the following [link](#).

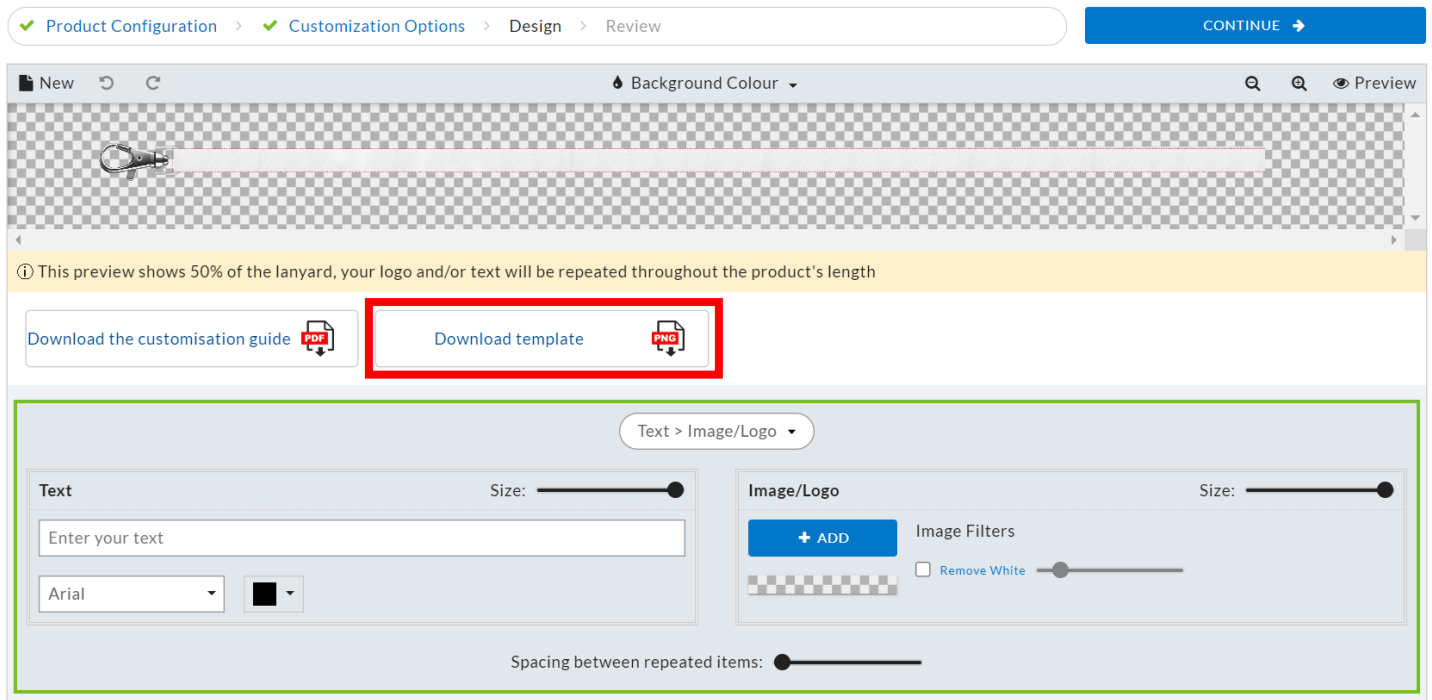

## 2. Customize the template

Customize the template by adding your own texts and images. The template only fits one side of the lanyard, your personalisation will automatically be replicated on the other side.

## 3. Upload your template online

When your template is ready, you can upload your file by clicking on the “add” button:

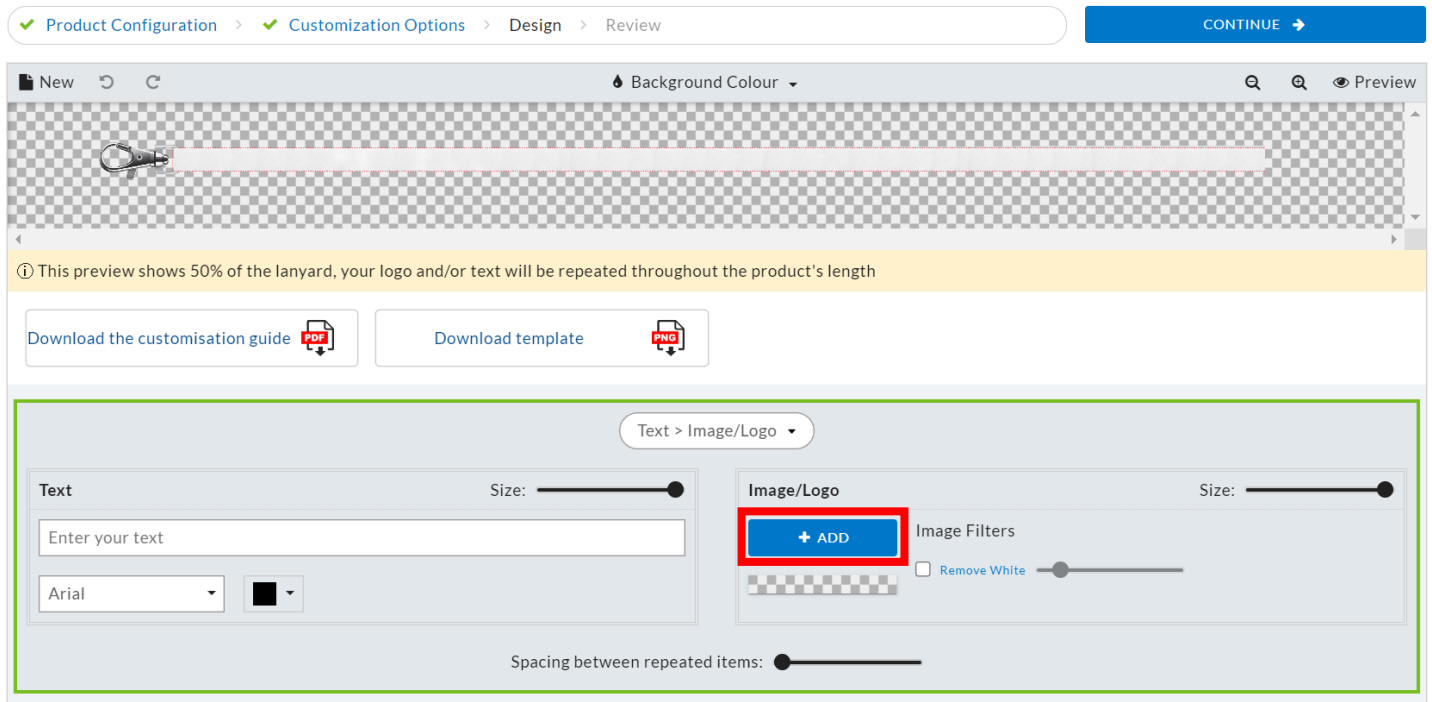

**Please note that if the image you use is smaller than our template, it will be repeated all along the lanyard.**

Drag or upload your file in the following window:

### Add Image/Clipart

Upload | Clipart Gallery

**i** Image upload requirements: JPG or PNG, 300-600 dpi or more. Max. width: 4500 px. Max. file size: 2 MB.



Drag an image here

OR

Choose an image to upload



**This product is printed on one side only, the reverse side will remain white. If you would like to have both sides printed, please contact us. Please use a legible font for your texts, texts that are too thin will not be readable when printed.**

#### **i Additional information:**

- The resolution of the file should be 300dpi or 600dpi.
- The following formats are accepted: JPG or PNG.
- The maximum size of the file is 2 Mo Max.